

Department of Engineering
Tim Bryan, P.E., County Engineer

3137 South Liberty Street, Canton, MS 39046
Office (601) 790-2525 FAX (601) 859-3430

MEMORANDUM

May 4, 2022

To: Sheila Jones, Supervisor, District I
Trey Baxter, Supervisor, District II
Gerald Steen, Supervisor, District III
Karl Banks, Supervisor, District IV
Paul Griffin, Supervisor, District V

From: Tim Bryan, P.E., PTOE
County Engineer

Re: AT&T Utility Permit
County Road Name, Bilbrew Road

The Engineering Department recommends approval of the permit application for AT&T to bore cable on East side of Bilbrew Road North from 134 Bilbrew Road then crossing road to 179 Bilbrew Road.

SHEILA JONES
District One

TREY BAXTER
District Two

GERALD STEEN
District Three

KARL BANKS
District Four

PAUL GRIFFIN
District Five



PERMIT APPLICATION FOR THE CONSTRUCTION OR ADJUSTMENT OF A UTILITY WITHIN COUNTY ROAD RIGHT-OF-WAY

Utility Information: Utility Name: ATT

Address: 370 CHURCH RD City/State/Zip: MADISON,MS 39110

Contact Person: DONNIE MILLER Contact's Phone: 601-521-8779

Project Information: County Road Name: BILBREW RD

(If located within more than one road right-of-way, use Appendix 1 for additional descriptions)

Beginning Location: F 134 BILBREW RD Ending Location: F 179 BILBREW RD

Length of Project: 2004 FT Section: 11 Township: T-9-N Range: R-4-E

Description of Work: BORE CABLE ON EAST SIDE OF BILBREW RD NORTH FROM 134 BILBREW RD THEN CROSSING ROAD TO 179 BILBREW RD

Check Box if Appendix 1 is to be included as a part of this Application

Whereas the above stated Utility makes application to the **Madison County Board of Supervisors** for a Construction Permit. Attached hereto are drawings and plans for the construction of the above facilities located within Madison County owned public rights-of-way. Once stamped by the Madison County Engineering Department, these plans shall not be changed or altered without written approval of the County Engineer, or his representative. A copy of the approved permit and plans shall be on-site at all times during construction.

The Applicant Utility shall comply with all policies, procedures and construction practices as outlined in *A Policy for The Accommodation of Utility Facilities within the Right-of-Way of all Public County Roads* (hereinafter referred to as the "Policy"), as adopted on November 1, 2005, by the **Madison County Board of Supervisors**, and which is hereby made a part of this Application Agreement.

If facilities are to be located within the Rights-of-Way of the County-Federal or State Aid System, Applicant Utility also agrees to comply with applicable provisions of *S.O.P. No. SA II-2-8, Accommodation of Utilities on Rights-of-Way*, issued by the State Aid Engineer and dated July 1, 2005.

The Applicant Utility understands and agrees that, except as herein granted, no right, title, claim, or easement to said road right-of-way is granted by the issuance of this permit. If this Utility is listed in the general provisions of the Policy, it will be adjusted to comply with same without cost to the County, unless the variance from the Policy has been approved by the granting of the Permit pursuant to this Application.

The Applicant Utility further understands that the Utility's engineering, plant, or other personnel will be responsible for the staking and construction supervision of the work set out above and as shown on the attached plans. If work impacts traffic in any way, the appropriate traffic control shall be installed per the *Manual of Uniform Traffic Control Devices*, Latest Edition.

The Applicant Utility understands that the County Engineer, or his representative, may issue a Stop Work Order at any time if it is deemed that site conditions are not suitable for construction or if any of the requirements of this permit are not being met.

Many County Roads have variable Rights-of-Way and/or no Right-of-Way at all and are maintained under a Prescriptive Easement. It is the sole responsibility of the Applicant Utility to verify the existence and limits of public rights-of-way. If none exists, it is the

responsibility of the Applicant Utility to acquire an easement for their Facilities from the applicable property owner(s). Madison County in no way verifies the limits of Right-of-Way as shown on the permit application.

The Applicant Utility shall be responsible for all future maintenance and repair of the facilities installed under this permit. The Applicant Utility shall make future adjustments to, or relocate, the facilities located within road or highway right-of-way when required for road or highway widening or other road or highway construction at no cost to Madison County. The Applicant Utility shall relocate said utilities within sixty (60) days of notification by County by registered mail, return receipt requested, unless otherwise designated by the County Engineer. Further, any maintenance, repair, or construction shall be done in such a manner as to occasion no unreasonable interference with the normal flow and safety to traffic and at the expense of the utility company. When reasonable care has been taken to locate said utility facilities within the right-of-way, the Applicant Utility understands that any damages caused by routine maintenance and construction by County forces shall be borne by the Applicant Utility.

The Applicant Utility further agrees to indemnify and hold Madison County harmless for any and all claims, accidents, damages, liabilities and expenses occasioned wholly, or in part, by any act or omission of applicant, its agents or employees. In case County shall, without fault on its own part, be made a party to any litigation commenced by or against applicant, then applicant shall protect and hold County harmless, and shall pay all costs, expenses and reasonable attorney's fees incurred or paid by County in connection with said litigation.

All underground facilities shall be installed at a depth equal to or greater than 48" below the lowest adjacent grade.

All pipes carrying liquid shall be encased under County maintained roads.

WITNESS the signature of the Applicant this the 4TH day of MAY, 2022.

By: DONNIE MILLER
(Applicant Signature)

Title: MANAGER OSP & ENGINEERING

Note: *Applicant must be an employee of the Utility named in this application. The Madison County Board of Supervisors will not recognize a Contractor, Subcontractor, Agent, or Consulting Engineer as the Applicant. Utility Company shall be fully responsible for all work performed under this application.*

I, or my authorized representative, have reviewed this application and determined that the drawing, sketches, and plans submitted by the Applicant meet the requirements of *A Policy for The Accommodation of Utility Facilities within the Right-of-Way of all Public County Roads.*

APPROVED
By *timothy.bryan at 8:39 am, May 10, 2022*
Tim Bryan, P.E.
County Engineer

AGREED TO AND APPROVED BY:

Madison County Board President

Date: _____

ENTERED INTO THE MINUTES OF THE BOARD OF SUPERVISORS OF MADISON COUNTY, MISSISSIPPI ON THIS _____ DAY OF _____, 20_____.

Appendix 1

County Road Name: _____
Beginning Location: _____ Ending Location: _____
Length of Project: _____ Section: _____ Township: _____ Range: _____
Description of Work: _____

County Road Name: _____
Beginning Location: _____ Ending Location: _____
Length of Project: _____ Section: _____ Township: _____ Range: _____
Description of Work: _____

County Road Name: _____
Beginning Location: _____ Ending Location: _____
Length of Project: _____ Section: _____ Township: _____ Range: _____
Description of Work: _____

County Road Name: _____
Beginning Location: _____ Ending Location: _____
Length of Project: _____ Section: _____ Township: _____ Range: _____
Description of Work: _____

County Road Name: _____
Beginning Location: _____ Ending Location: _____
Length of Project: _____ Section: _____ Township: _____ Range: _____
Description of Work: _____

LOCATION MAP



1 45C
2 TESTC
1176R:78 & 80

F 1176 ROBINSON RD
SCXH-1000S (1997) 45C
IN PG10, 2001-2096
<8204298> IN CE2251A, 1-4
IN PG9, 1-96
<8204298> IN CE2251A, 101-104
IN A, 201-296
<8204298> IN CE2251A, 5-8
IN A, 301-396
<8204298> IN CE2251A, 105-108
OUT 1176R, 1-600

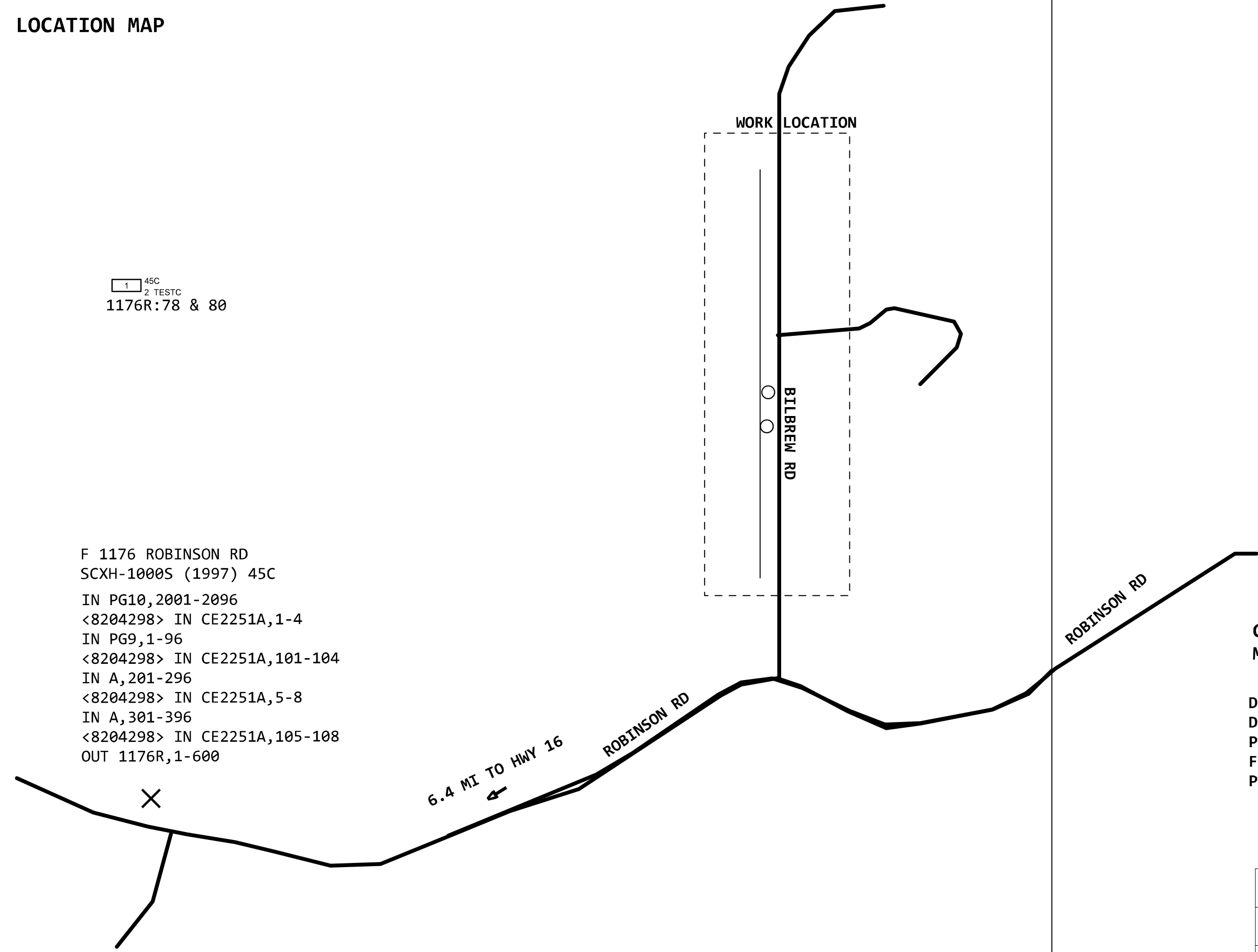

**COUNTY: MADISON
MUNICIPALITY: CANTON**

**DESIGNER CO: BYERS ENG. CO.
DESIGNER CAMERON WILLIAMS
PHONE #: 256-658-4028
FIELDER: DAVID NOKES
PHONE #: 662-392-9701**

| | | |
|---------------------------------|------------------|------------------------------|
| PROJECT # A02BG48 | | DATE SVC REQ'D 06/26/2022 |
| NPANNX 601859 | GEO LOC 72101 | CLLI cntnmsma |
| PRIMARY ENGR.: MILLER, DONALD M | | |
| ENGR. ID: DM5222 | PERMIT REQ'D. | N |
| PHONE #: 7694289316 | PRINT | 1 OF 4 |

SEE DWG 3

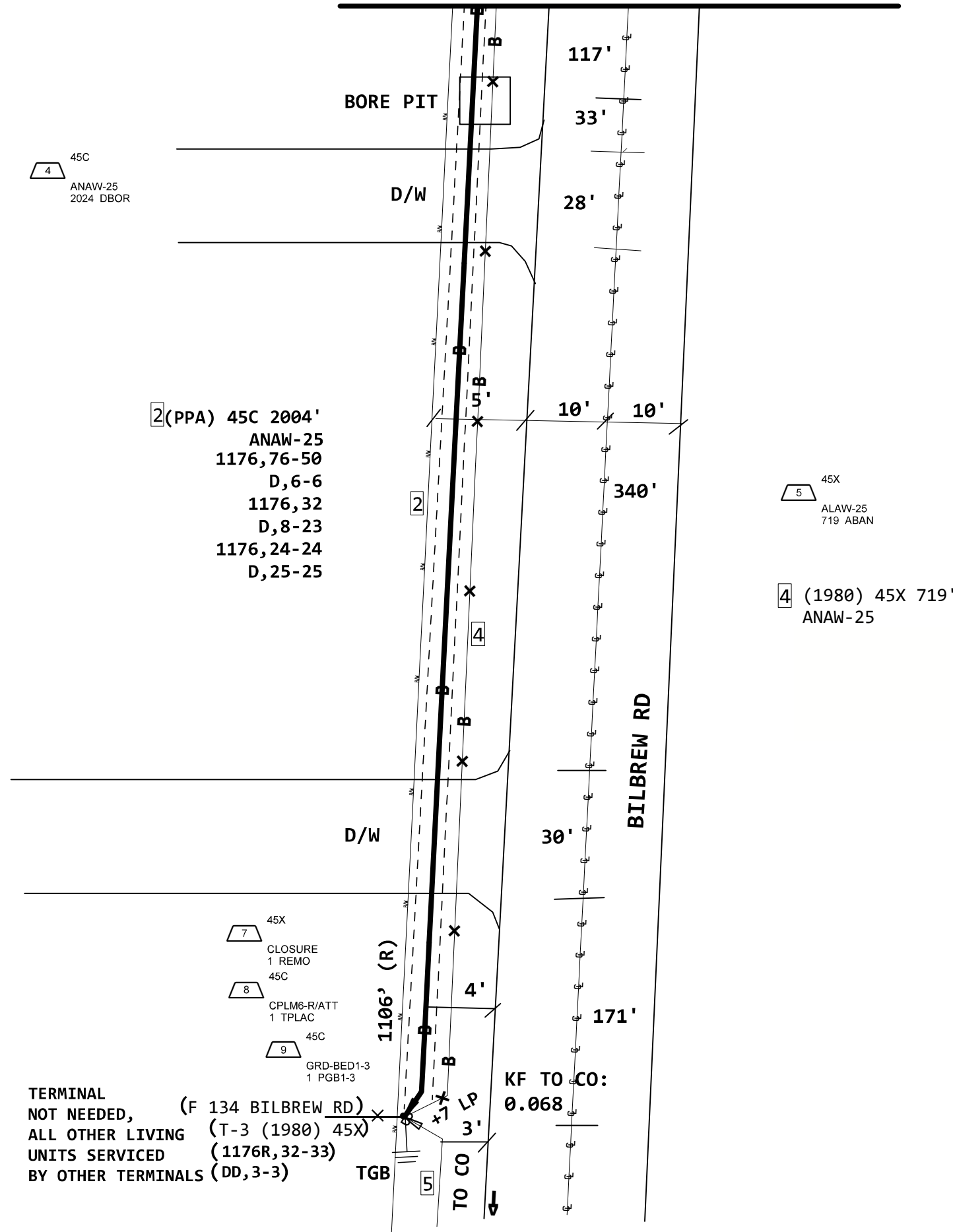

45C
4 ANAW-25
2024 DBOR

2 (PPA) 45C 2004'
ANAW-25
1176, 76-50
D, 6-6
1176, 32
D, 8-23
1176, 24-24
D, 25-25

45X
5 ALAW-25
719 ABAN

4 (1980) 45X 719'
ANAW-25

5 (1980) 45C(1760) 1041'
ALAW-25
D, 1-14
1176R, 32-33
1176R, 76-80
1176R, 24-24
D, 23-25

7 45X
CLOSURE
1 REMO
45C

8 CPLM6-R/ATT
1 TPLAC

9 45C
GRD-BED1-3
1 PGB1-3

TERMINAL
NOT NEEDED,
ALL OTHER LIVING (F 134 BILBREW RD)
UNITS SERVICED (T-3 (1980) 45X)
BY OTHER TERMINALS (1176R, 32-33)
(DD, 3-3)

45C
6 SPL

| | | | |
|---------------------------------|------------------|------------------------------|---|
| PROJECT # A02BG48 | | DATE SVC REQ'D 06/26/2022 | |
| NPANNX 601859 | GEO LOC 72101 | CLLI cntnmsma | |
| PRIMARY ENGR.: MILLER, DONALD M | | | |
| ENGR. ID: DM5222 | | PERMIT REQ'D. | N |
| PHONE #: 7694289316 | | PRINT 2 OF 4 | |

SEE DWG 4

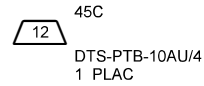
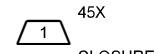
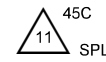

F 192.1 BILBREW RD

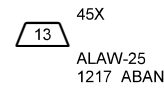

1 (1980) 45X 1217'
ALAW-25
D,1-14
1176R,33-33
1176R,76-80
D,20-23
1176R,24-24

2 (PPA) 45C 2004'
ANAW-25
1176,76-50
D,6-6
1176,32
D,8-23
1176,24-24
D,25-25

3 (1980) 22X 77'
BKMS-25
D,1-14
1176R,33-33
1176R,76-80
D,20-23
1176R,24-24

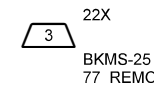

1-6.6M
22/22
SRW-3

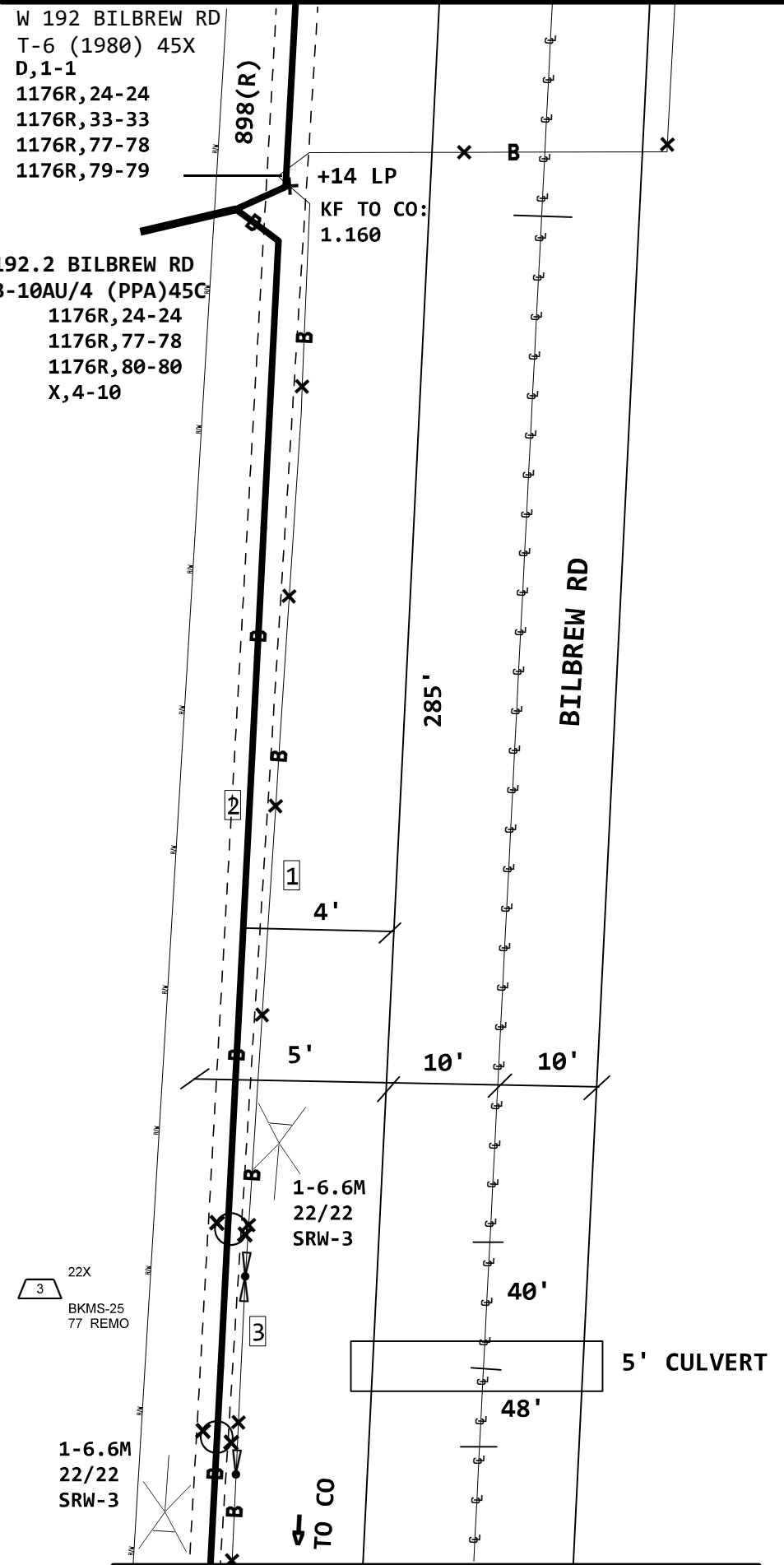

SEE DWG 2

BORE PROFILE
FACING WEST

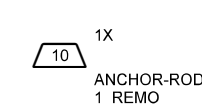
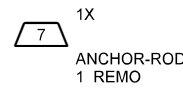
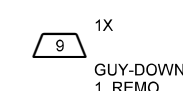
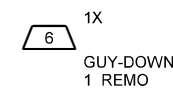
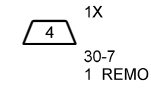
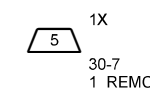
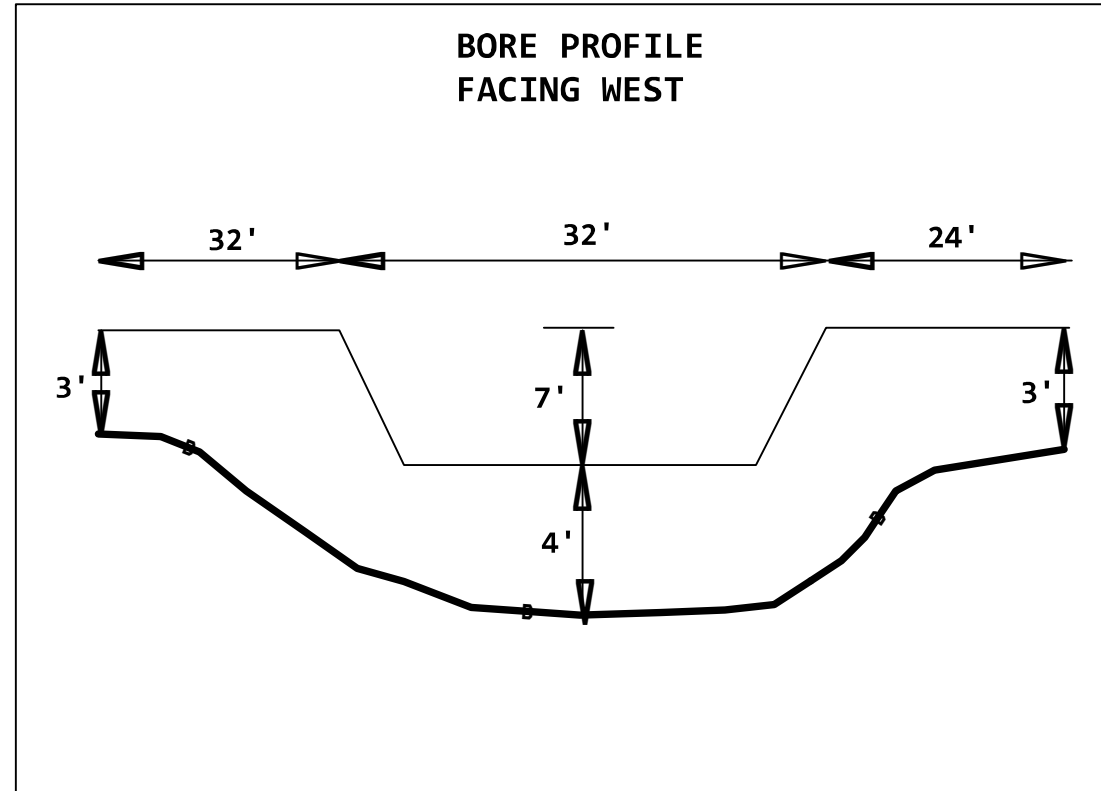

| | | |
|---------------------------------|------------------|------------------------------|
| PROJECT # A02BG48 | | DATE SVC REQ'D 06/26/2022 |
| NPANNX 601859 | GEO LOC 72101 | CLLI cntnmsma |
| PRIMARY ENGR.: MILLER, DONALD M | | |
| ENGR. ID: DM5222 | PERMIT REQ'D. | N |
| PHONE #: 7694289316 | PRINT 3 OF 4 | |

1 (1980) 45X 1217'
 ALAW-25
 D,1-14
 1176R,33-33
 1176R,76-80
 D,20-23
 1176R,24-24

2 (PPA) 45C 2004'
 ANAW-25
 D,1-14
 1176R,33-33
 1176R,76-80
 D,20-23
 1176R,24-24

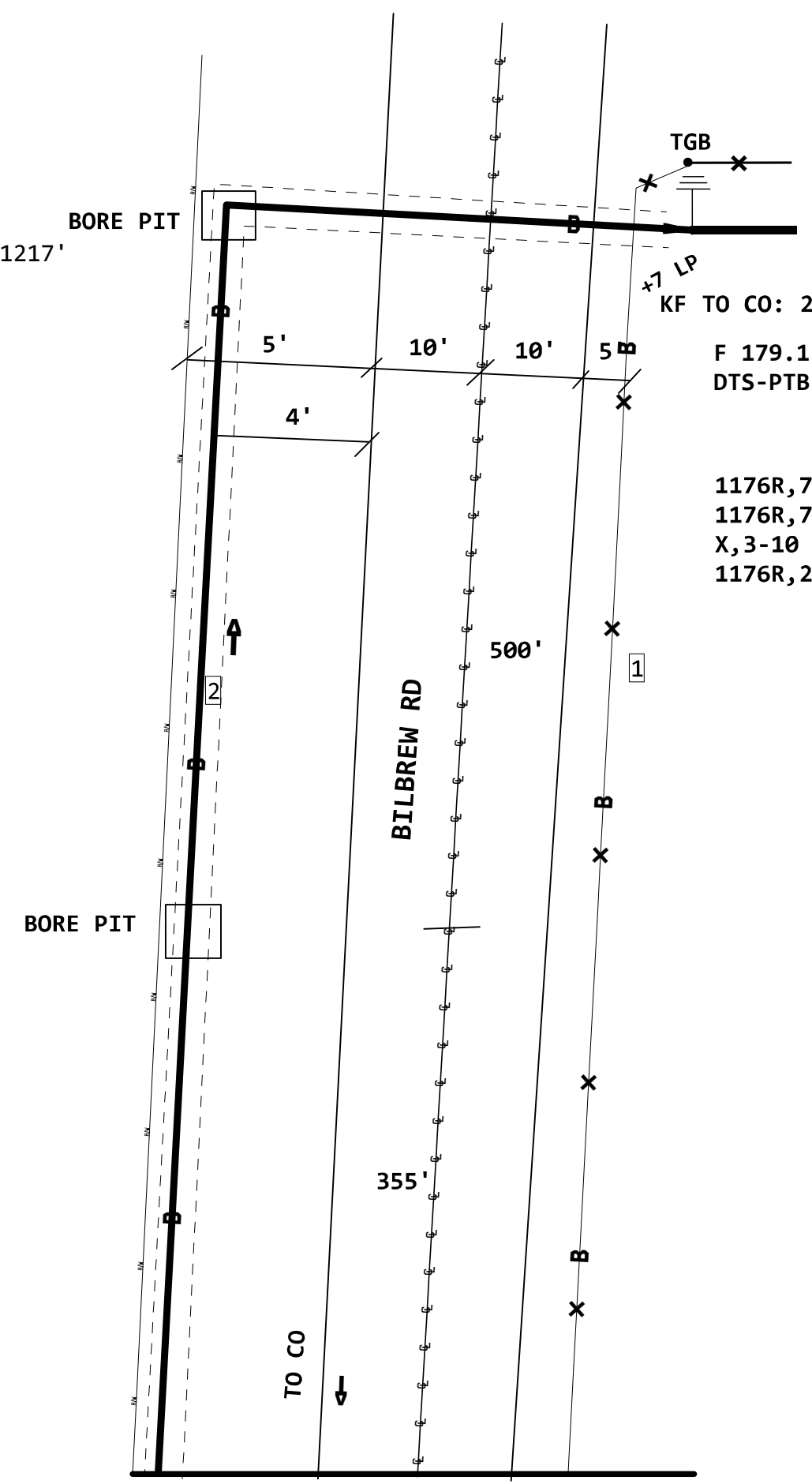

(PED 179.1 BILBREW RD)
 (T-25 (1980) 45X)
 (D,1-14)
 (1176R,33)
 (1176R,76-80)
 (D,21-24)
 (1176R,24-24)

F 179.1 BILBREW RD
 DTS-PTB-10AU/4 (PPA)45C

1176R,76-76
 1176R,78-78
 X,3-10
 1176R,24-24

45C
 9
 DTS-PTB-10AU/4
 1 PLAC
 F 179.1 BILBREW RD

45X
 10
 T-25
 1 REMO

45C
 8
 SPL

45C
 7
 CPLM6-I/ATT
 1 PLAC

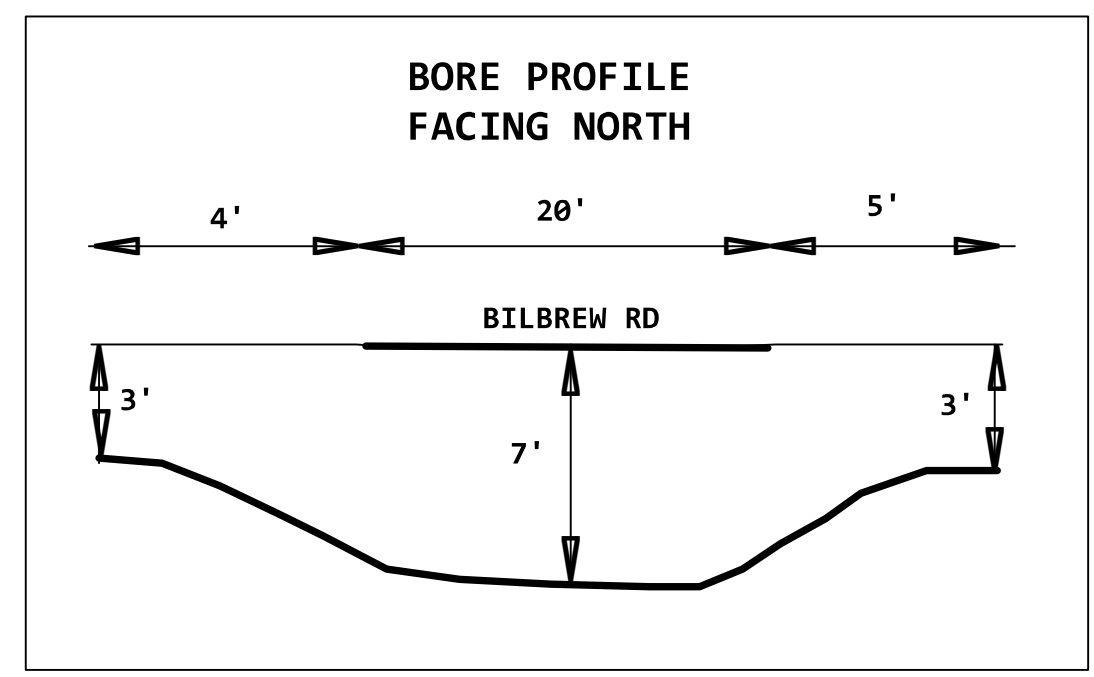

SEE DWG 3



| | | |
|---------------------------------|------------------|------------------------------|
| PROJECT # A02BG48 | | DATE SVC REQ'D 06/26/2022 |
| NPANNX 601859 | GEO LOC 72101 | CLLI cntnmsma |
| PRIMARY ENGR.: MILLER, DONALD M | | |
| ENGR. ID: DM5222 | PERMIT REQ'D. | N |
| PHONE #: 7694289316 | PRINT 4 OF 4 | |